4DWG10 Series Solenoid Operated Directional Control Valves

4DWG10型电磁换向阀

4DWG10 SERIES SOLENOID OPERATED DIRECTIONAL CONTROL VALVES



4DWG10 型方向控制阀是电磁铁操纵的换向阀,用以控制油液的开启、停止和换向。

4DWG10 series directional control valves are solenoid operated directional spool valves, these valves are used to the start, stop and direct flow.

▶ 技术参数 Technical data

通径 Size		10
最大流量 (L/min) Max. flow rate (L/min)		120
工作压力 (MPa) Operating pressure (MPa)		A、B、P 油口 31.5/A、B、P oil port 31.5 T 油口 16/T oil port 16
重量 (千克) Weight (KGS)	单头 valve with one solenoid	4.6
	双头 valve with two solenoids	6
阀体 (材料) 表面处理 Valve body (Material) Surface treatment		铸件 表面磷化处理 Casting phosphating surface
油液清洁度/Oil cleanliness		NAS1638 9级和 ISO4406 20/18/15级 NAS1638 class 9 and ISO4406 class 20/18/15

▶ 特性曲线 (在使用 HLP46, $\vartheta_{油}=40^{\circ}\text{C}\pm 5^{\circ}\text{C}$ 测得)

Characteristic curves (measured with HLP46, $\text{Voil}=40^{\circ}\text{C}\pm 5^{\circ}\text{C}$)

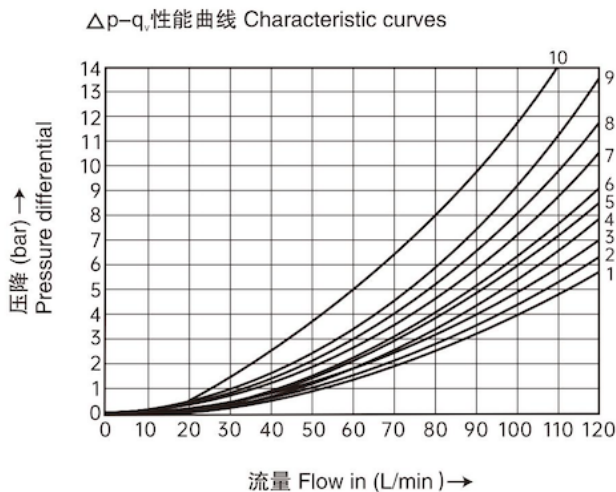

8 机能符号“R”处于控制位置 b (B \rightarrow A)

机能符号 Spool symbol	流向 Flow direction				
	P-A	P-B	A-T	B-T	
A;B	3	3	-	-	
C	3	3	4	5	
D;Y	5	5	6	6	
E	1	1	4	4	
F	2	3	7	4	
G	3	3	6	7	
H	1	1	6	7	
J	1	1	3	3	
L	2	2	3	5	
M	1	1	4	5	
P	4	2	5	7	
Q	1	2	1	3	
R	3	6	4	-	
T	3	3	6	7	
U;V	2	2	3	3	
W	2	2	4	5	
接通位置 On-position	P-A	B-A	A-T	P-T	
R	-	9	-	-	
	P-A	P-B	B-T	A-T	P-T
F	4	-	-	9	9
9	-	5	8	-	10
G;T			-	-	9
H			-	-	3

机能符号 Spool symbols

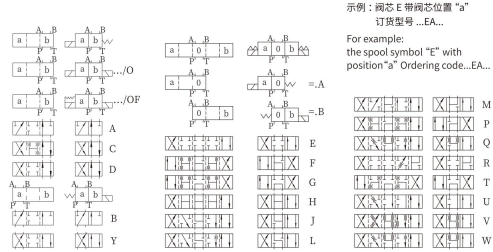

DWG10 外型尺寸 DWG10 Subplate Overall Dimensions

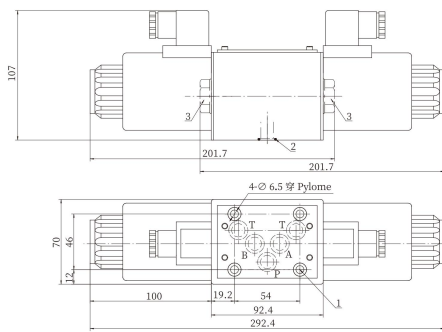

- | | |
|--|--|
| 1. 阀固定螺丝:
4个 M6×40GB/T70.1-12.9 级
拧紧扭矩 Ma=15.5Nm | 1.Valve's set screw:
4 of M6 x 40 GB/T70.1-12.9
Tightening torque Ma=15.5Nm. |
| 2. O 型圈 φ 16×1.9 | 2.O-ring φ 16 x 1.9 |
| 3. 用于 1 个电磁铁阀的堵头 | 3.Plug screw for valves with one solenoid. |

4DWG10 底板安装尺寸 4DWG10 Overall Subplate Installation Dimensions

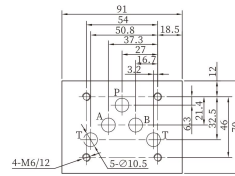

Z1DS10, Z2DS10, Z2FDS10, ZPB10, ZPR10
安装尺寸相同
Installations are the same with
Z1DS10, Z2DS10, Z2FDS10, ZPB10, ZPR10

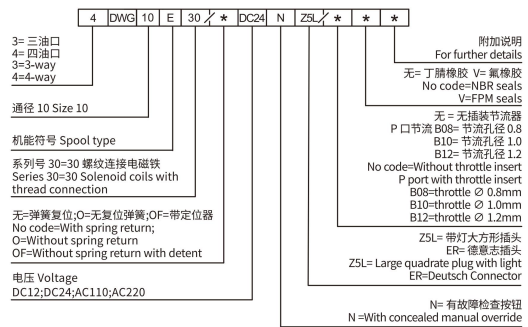

Product link : <https://www.hanshang-hydraulic.com/?p=423380>